



Directory

Echo Lake Subdivision

City of Byrnes Mill

(November 9, 2012)

This is a listing of Echo Lake property owners in lot number order. This was originally compiled by Grant MacLaren (Lot 29), using information provided by lot owners, Bill Williams Construction Co. and the City of Byrnes Mill. To request your phone number and/or email address be added, or to request an entry be revised, please contact Doug Mehringer (current Board Member) who now maintains this document.

The most recent version of this document is on the Internet at www.grantmaclaren.com/echolake

1. Renken, David and Deadra
3291 Echo Lake Drive,
Byrnes Mill, MO 63025
636-677-3064
2. Schnorbus, John and Joy and Long, Bill and Cathy
3287 Echo Lake Drive,
Byrnes Mill MO 63025
3. **VACANT LOT**
3279 Echo Lake Drive
Byrnes Mill, MO 63025
4. **VACANT LOT**
3275 Echo Lake Drive
Byrnes Mill, MO 63025
5. **VACANT LOT**
3271 Echo Lake Drive
Byrnes Mill, MO 63025
6. Mehringer, Doug and Holly
3267 Echo Lake Drive
Byrnes Mill, MO 63025
314-467-0505
doug@mehringeronline.com
7. **VACANT LOT**
3261 Echo Lake Drive
Byrnes Mill, MO 63025
8. **VACANT LOT**
3245 Echo Lake Drive
Byrnes Mill, MO 63025
9. Wekenborg, Mark and Lisa
3241 Echo Lake Drive
Byrnes Mill, MO 63025
10. Roeslein, Joe and Carrie
3237 Echo Lake Drive
Byrnes Mill, MO 63025
11. **VACANT LOT**
32?? Echo Lake Drive
Byrnes Mill, MO 63025
12. **VACANT LOT**
3229 Echo Lake Drive
Byrnes Mill, MO 63025

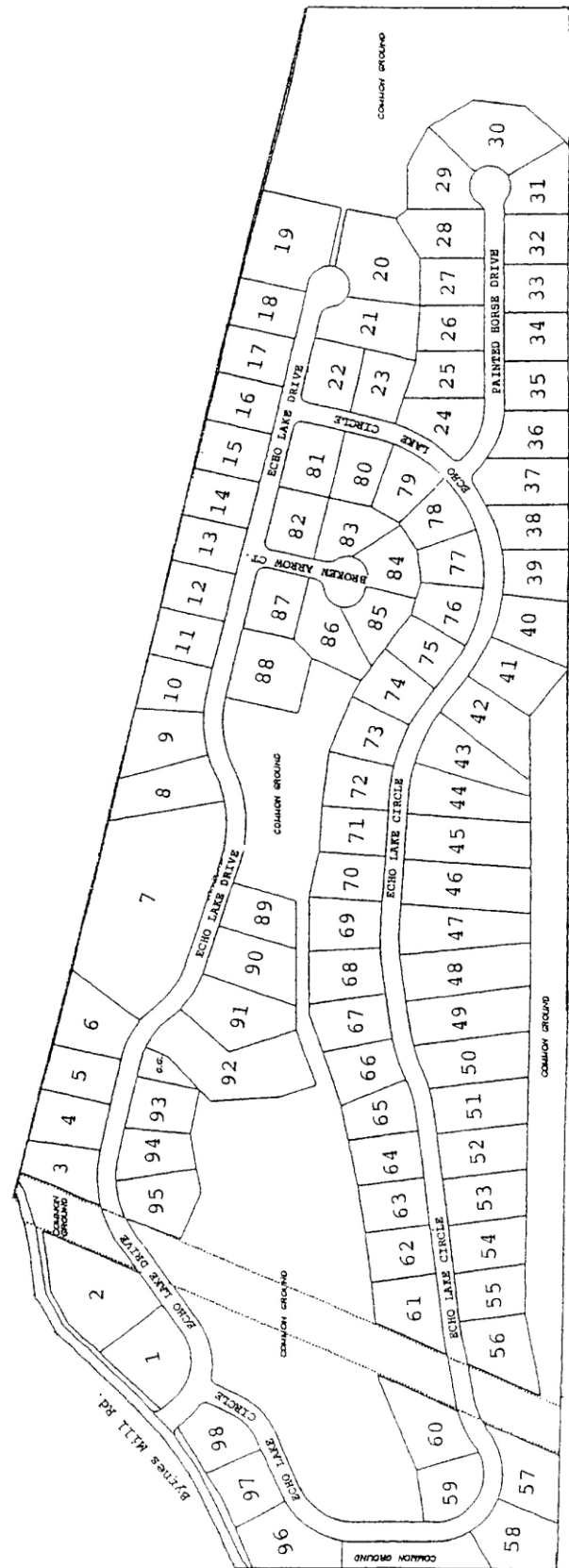

13. **VACANT LOT**
3225 Echo Lake Drive
Byrnes Mill, MO 63025

14. Elterman, James and Holly
3221 Echo Lake Drive
Byrnes Mill, MO 63025
15. **VACANT LOT**
3217 Echo Lake Drive
Byrnes Mill, MO 63025
16. **VACANT LOT**
3213 Echo Lake Drive
Byrnes Mill, MO 63025
17. Hanewinkel, Jeff and Angela
3209 Echo Lake Drive
Byrnes Mill, MO 63025
18. Ledwidge, Liz
3205 Echo Lake Drive
Byrnes Mill, MO 63025
19. Wegner, Mike and Robyn
3201 Echo Lake Drive
Byrnes Mill, MO 63025
314-302-2164
robynwegner@aol.com
20. Whitehead, John and Susan
3200 Echo Lake Drive
Byrnes Mill, MO 63025
21. Shumate, Frank and Peggy
3204 Echo Lake Drive
Byrnes Mill, MO 63025
22. Vessells, Paul and Julia
3208 Echo Lake Drive
Byrnes Mill, MO 63025
23. **VACANT LOT**
106 Echo Lake Circle
Byrnes Mill, MO 63025
24. **VACANT LOT**
110 Echo Lake Circle
Byrnes Mill, MO 63025
3125 Painted Horse Drive
Byrnes Mill, MO 63025
25. **VACANT LOT**
3119 Painted Horse Drive
Byrnes Mill, MO 63025
26. **VACANT LOT**
3115 Painted Horse Drive
Byrnes Mill, MO 63025
27. **VACANT LOT**
3111 Painted Horse Drive,
Byrnes Mill, MO 63025
28. **VACANT LOT**
3107 Painted Horse Drive,
Byrnes Mill, MO 63025
29. MacLaren, Grant and Phyllis
3103 Painted Horse Drive
Byrnes Mill, MO 63025
314-560-2054
grant@grantmaclaren.com
30. Stoltz, Glennon
3100 Painted Horse Drive
Byrnes Mill, MO 63025
31. **VACANT LOT**
3104 Painted Horse Drive
Byrnes Mill, MO 63025
31. Johnson, Robert and Mary
3106 Painted Horse Drive
Byrnes Mill, MO 63025
32. **VACANT LOT**
3108 Painted Horse Drive
Byrnes Mill, MO 63025
33. Jung, Thomas and Mary
3112 Painted Horse Drive
Byrnes Mill, MO 63025
34. **VACANT LOT**
3116 Painted Horse Drive
Byrnes Mill, MO 63025
35. Grither, Gerald and Amber
3120 Painted Horse Drive
Byrnes Mill, MO 63025
36. Buchheit, Ron and Lynn
3124 Painted Horse Drive
Byrnes Mill, MO 63025
37. Brown, Harold and Connie
114 Echo Lake Circle
Byrnes Mill, MO 63025
38. Wilms, Jeff and Strayhorn, Kate
118 Echo Lake Circle
Byrnes Mill, MO 63025
39. Vigil, Mark and Laurie
122 Echo Lake Circle
Byrnes Mill, MO 63025
40. Conway, Adam and Sarah
126 Echo Lake Circle
Byrnes Mill, MO 63025
41. **VACANT LOT**
130 Echo Lake Circle
Byrnes Mill, MO 63025
42. Lewellen, Larry and Kristen
134 Echo Lake Circle
Byrnes Mill, MO 63025
43. Johnson, Tom and Sara
140 Echo Lake Circle
Byrnes Mill, MO 63025
44. Sanson, Devin and Melissa
146 Echo Lake Circle
Byrnes Mill, MO 63025
45. Houska, Steven and Barbara
150 Echo Lake Circle
Byrnes Mill, MO 63025
46. Thomlison, Tom and Tina
154 Echo Lake Circle
Byrnes Mill, MO 63025
47. Mayfield, Donald and Laurel
158 Echo Lake Circle
Byrnes Mill, MO 63025
48. Etter, Bob and Teresa
162 Echo Lake Circle
Byrnes Mill, MO 63025
49. Behen, Robert and Julie
166 Echo Lake Circle
Byrnes Mill, MO 63025
50. Brewer, Jim and Nancy
170 Echo Lake Circle
Byrnes Mill, MO 63025
51. Yount, Nick and Amy
174 Echo Lake Circle,
Byrnes Mill, MO 63025
52. Burnett, Al and Ellenor
178 Echo Lake Circle
Byrnes Mill, MO 63025
53. Nicholson, Christopher and Elizabeth
182 Echo Lake Circle
Byrnes Mill, MO 63025

54. Ponder, Glennon and Faye
186 Echo Lake Circle
Byrnes Mill, MO 63025
636-677-5678
55. **VACANT LOT**
190 Echo Lake Circle
Byrnes Mill, MO 63025
56. Kohl, Mark and Bonita
194 Echo Lake Circle
Byrnes Mill, MO 63025
57. **VACANT LOT**
200 Echo Lake Circle
Byrnes Mill, MO 63025
58. **VACANT LOT**
204 Echo Lake Circle
Byrnes Mill, MO 63025
59. **VACANT LOT**
203 Echo Lake Circle
Byrnes Mill, MO 63025
60. **VACANT LOT**
199 Echo Lake Circle
Byrnes Mill, MO 63025
61. Sisson, Gil and Linda
191 Echo Lake Circle
Byrnes Mill, MO 63025
62. **VACANT LOT**
183 Echo Lake Circle
Byrnes Mill, MO 63025
63. Unger, Kenneth
181 Echo Lake Circle
Byrnes Mill, MO 63025
64. Colbert, Paul and Mandi
177 Echo Lake Circle
Byrnes Mill, MO 63025
65. May, Brian and Amy
173 Echo Lake Circle
Byrnes Mill, MO 63025
66. Obermoeller, Michael & Joan
169 Echo Lake Circle
Byrnes Mill, MO 63025
67. Morris, Richard (Rick) and Lisa
165 Echo Lake Circle
Byrnes Mill, MO 63025
68. Birdwell, Margaret
161 Echo Lake Circle
Byrnes Mill, MO 63025
69. Kroeger, David and Gina
157 Echo Lake Circle
Byrnes Mill, MO 63025
70. Midyett, Bob and Karen
153 Echo Lake Circle
Byrnes Mill, MO 63025
cell 314-452-6975
71. Friebel, Tim and Jen
149 Echo Lake Circle
Byrnes Mill, MO 63025
72. Mitchell, Greg and Bridget
145 Echo Lake Circle
Byrnes Mill, MO 63025
73. Brown, Jason and Christie
141 Echo Lake Circle
Byrnes Mill, MO 63025
74. Jeffries, James and Kara
137 Echo Lake Circle
Byrnes Mill, MO 63025

75. Rogers, Nancy
133 Echo Lake Circle
Byrnes Mill, MO 63025
76. **VACANT LOT**
127 Echo Lake Circle
Byrnes Mill, MO 63025
77. **VACANT LOT**
121 Echo Lake Circle
Byrnes Mill, MO 63025
78. **VACANT LOT**
113 Echo Lake Circle
Byrnes Mill, MO 63025
79. **VACANT LOT**
109 Echo Lake Circle
Byrnes Mill, MO 63025
80. **VACANT LOT**
105 Echo Lake Circle
Byrnes Mill, MO 63025
81. **VACANT LOT**
3216 Echo Lake Drive
Byrnes Mill, MO 63025
82. Depp, David and Jerri
2 Broken Arrow Circle
Byrnes Mill, MO 63025
83. **VACANT LOT**
4 Broken Arrow Circle
Byrnes Mill, MO 63025
84. **VACANT LOT**
6 Broken Arrow Circle,
Byrnes Mill, MO 63025
85. **VACANT LOT**
5 Broken Arrow Circle
Byrnes Mill, MO 63025
86. **VACANT LOT**
3 Broken Arrow Circle
Byrnes Mill, MO 63025
87. **VACANT LOT**
1 Broken Arrow Circle
Byrnes Mill, MO 63025
(possibly 3216 Echo Lake Drive)
88. Emde, Bob and Deanie
3234 Echo Lake Drive
Byrnes Mill, MO 63025
89. **VACANT LOT**
3252 Echo Lake Drive
Byrnes Mill, MO 63025
90. **VACANT LOT**
3256 Echo Lake Drive
Byrnes Mill, MO 63025
91. **VACANT LOT**
3260 Echo Lake Drive
Byrnes Mill, MO 63025
92. **VACANT LOT**
3264 Echo Lake Drive
Byrnes Mill, MO 63025
93. **VACANT LOT**
3272 Echo Lake Drive
Byrnes Mill, MO 63025
94. Tonya Cole
3276 Echo Lake Drive
Byrnes Mill, MO 63025
95. Bunton, Jim and Barb
3280 Echo Lake Drive
Byrnes Mill, MO 63025
96. Lacey, Kevin and Brooke
216 Echo Lake Circle
Byrnes Mill, MO 63025

97. **VACANT LOT**

220 Echo Lake Circle
Byrnes Mill, MO 63025

98. Koch II, Steven and Cynthia
3294 Echo Lake Drive,
Byrnes Mill, MO 63025
636-748-0032

Echo Lake Subdivision Restrictions

Homeowners in Echo Lake have agreed to restrictions set forth in a formal declaration signed upon closing on their property and filed with Jefferson County. Following is an unofficial summary of numbered restrictions:

1. The size and construction of homes and buildings is set forth in the restrictions. Lots are restricted to residential use only.
2. No house trailers or temporary living quarters are permitted.
3. Plans for all buildings and landscaping must be approved in writing and construction completed within one year's time.
4. Driveways must be 4-inch thick concrete slab.
5. Roofs must be approved shingle.
6. Carports are not permitted.
7. Sewers must be approved by City of Byrnes Mill.
8. Set-back lines must be approved by City of Byrnes Mill.
9. Limit of two domestic pets per house. No animals permitted to run loose.
10. Exteriors of residences must be kept neat, orderly and trash-free. Weeds must be kept cut. Autos and machines not in regular use must be kept out of sight, within a permanent building.
11. Detached garages or outbuildings must be approved in writing, and constructed of materials equal to, and similar in aesthetic value to, the home.

12. Maintenance of streets and drives is the responsibility of the homeowners.
13. Restrictions herein can be amended by 2/3 vote of dues-paid property owners. (One vote per lot.)
14. Prohibited: boarding house, nursing home, rooming house, club house or road house, or any activity which becomes a nuisance.
15. No signs, ads or billboards. One real estate "for sale" yard sign of usual standard size per lot permitted.
16. Lots/homes may not be leased, sub-leased or re-subdivided without written consent of board and approval by City of Byrnes Mill.
17. No overnight parking on streets of subdivision. No unlicensed, disabled or infrequently-used vehicle to be parked outside in subdivision.
18. These restrictions are enforceable.

Other information:

Trash hauling shall be by only one company. This is to keep subdivision street damage by heavy trucks to a minimum. Currently, Affordable Hauling, 636-376-3891 is our hauler.

The subdivision is in Ward 2 in the City of Byrnes Mill. Our ZIP code is 63025 and our Post Office is in Eureka. (Byrnes Mill is served by three post offices and three ZIP codes are used within the city.)

Echo Lake subdivision is a "Planned Use Development" complying with ordinances of Byrnes Mill.

City of Byrnes Mill's website:
www.byrnesmill.org