



## Directory

### Echo Lake Subdivision

### City of Byrnes Mill

(October 30, 2009)

This is a listing of Echo Lake property owners in lot number order. Compiled by Grant MacLaren (Lot 29), using information provided by lot owners, Bill Williams Construction Co. and the City of Byrnes Mill. To request your phone number and/or email address be added, or to request an entry be revised, please contact Grant.

The most recent version of this document is on the Internet at [www.echolake.info](http://www.echolake.info).

1. Renken, David and Deadra  
3291 Echo Lake Drive,  
Byrnes Mill MO 63025  
636-677-3064
2. Schnorbus, John and Jay and Long, Bill and Cathy  
3287 Echo Lake Drive,  
Byrnes Mill MO 63025
3. VACANT LOT  
3279 Echo Lake Drive  
Byrnes Mill MO 63025
4. VACANT LOT  
3275 Echo Lake Drive  
Byrnes Mill MO 63025
5. VACANT LOT  
3271 Echo Lake Drive  
Byrnes Mill MO 63025
6. Buckingham, Noel and Dawn  
3267 Echo Lake Drive  
Byrnes Mill MO 63025
7. VACANT LOT  
3261 Echo Lake Drive  
Byrnes Mill MO 63025
8. VACANT LOT  
3245 Echo Lake Drive  
Byrnes Mill MO 63025
9. Wekenborg, Mark and Lisa  
3241 Echo Lake Drive  
Byrnes Mill MO 63025
10. Roeslein, Joe and Carrie  
3237 Echo Lake Drive  
Byrnes Mill MO 63025
11. VACANT LOT  
3237 Echo Lake Drive  
Byrnes Mill MO 63025
12. VACANT LOT  
3229 Echo Lake Drive  
Byrnes Mill MO 63025

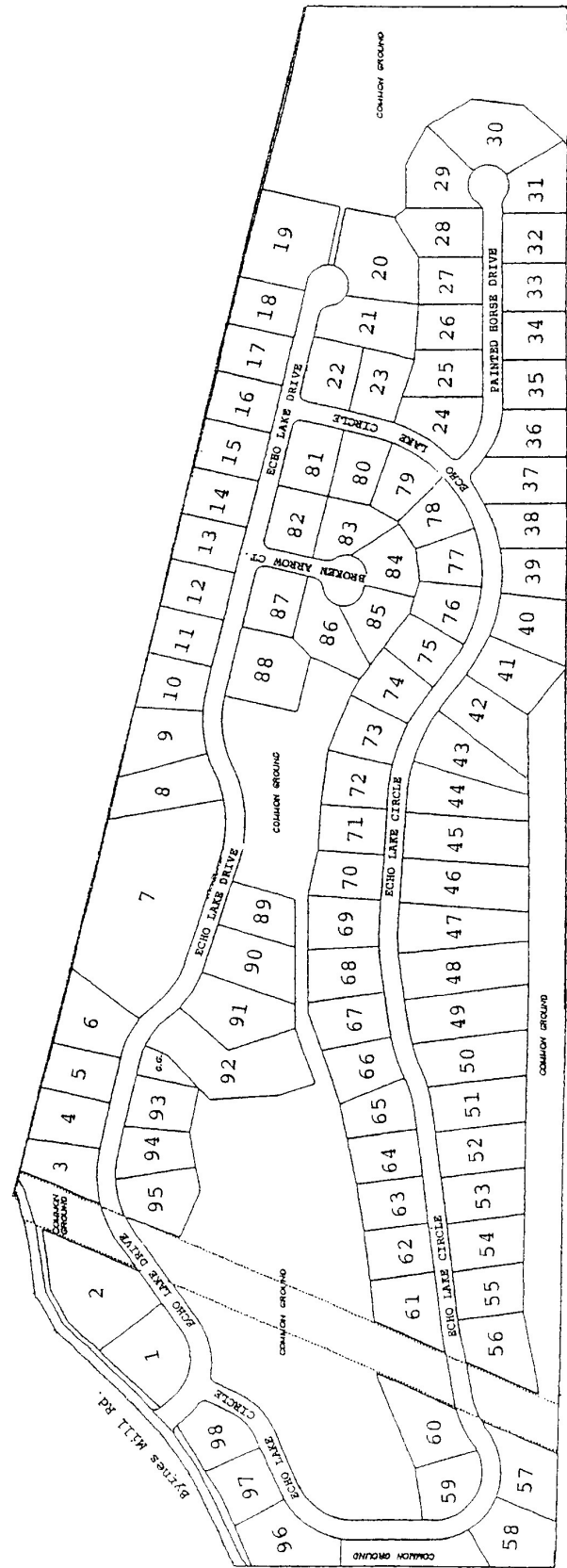

13. VACANT LOT  
3225 Echo Lake Drive  
Byrnes Mill MO 63025
14. Dunavant, Bill and Libby  
3221 Echo Lake Drive  
Byrnes Mill MO 63025
15. VACANT LOT  
3217 Echo Lake Drive  
Byrnes Mill MO 63025
16. VACANT LOT  
3213 Echo Lake Drive  
Byrnes Mill MO 63025
17. Hanewinkel, Jeff and Angela  
3209 Echo Lake Drive  
Byrnes Mill MO 63025
18. Ledwidge, Liz  
3205 Echo Lake Drive  
Byrnes Mill MO 63025
19. Wegner, Mike and Robin  
3201 Echo Lake Drive  
Byrnes Mill MO 63025
20. Whitehead, John and Susan  
3200 Echo Lake Drive  
Byrnes Mill MO 63025
21. Shumate, Frank and Peggy  
3204 Echo Lake Drive  
Byrnes Mill MO 63025
22. Barrett, Jason and Jackie  
3208 Echo Lake Drive  
Byrnes Mill MO 63025
23. VACANT LOT  
106 Echo Lake Circle  
Byrnes Mill MO 63025
24. VACANT LOT  
110 Echo Lake Circle  
Byrnes Mill MO 63025  
3125 Painted Horse Drive  
Byrnes Mill MO 63025
25. VACANT LOT  
3119 Painted Horse Drive  
Byrnes Mill MO 63025
26. VACANT LOT  
3115 Painted Horse Drive  
Byrnes Mill MO 63025
27. VACANT LOT  
3111 Painted Horse Drive,  
Byrnes Mill MO 63025
28. VACANT LOT  
3107 Painted Horse Drive,  
Byrnes Mill MO 63025
29. MacLaren, Grant and Phyllis  
3103 Painted Horse Drive  
Byrnes Mill MO 63025  
314-560-2054  
[grant@grantmaclaren.com](mailto:grant@grantmaclaren.com)
30. Stoltz, Glennon  
3100 Painted Horse Drive  
Byrnes Mill MO 63025
31. VACANT LOT  
3104 Painted Horse Drive  
Byrnes Mill MO 63025
31. ACCESS TO  
Johnson, Robert and Mary

- 3106 Painted Horse Drive  
Byrnes Mill MO 63025
32. VACANT LOT  
3108 Painted Horse Drive  
Byrnes Mill MO 63025
33. Jung, Thomas and Mary  
3112 Painted Horse Drive  
Byrnes Mill MO 63025
34. VACANT LOT  
3116 Painted Horse Drive  
Byrnes Mill MO 63025
35. VACANT LOT  
3120 Painted Horse Drive  
Byrnes Mill MO 63025
36. Buchheit, Ron and Lynn  
3124 Painted Horse Drive  
Byrnes Mill MO 63025
37. Brown, Harold and Connie  
114 Echo Lake Circle  
Byrnes Mill MO 63025
38. Wilms, Jeff and Stayhorn, Kate  
118 Echo Lake Circle  
Byrnes Mill MO 63025
39. Vigil, Mark and Laurie  
122 Echo Lake Circle  
Byrnes Mill MO 63025
40. Hauser, Don and Rebecca (Becky)  
126 Echo Lake Circle  
Byrnes Mill MO 63025  
314-574-6035
41. VACANT LOT  
130 Echo Lake Circle  
Byrnes Mill MO 63025
42. Lewellen, Larry and Kristen  
134 Echo Lake Circle  
Byrnes Mill MO 63025
43. Johnson, Tom and Sara  
140 Echo Lake Circle  
Byrnes Mill MO 63025
44. Sanson, Devin and Melissa  
146 Echo Lake Circle  
Byrnes Mill MO 63025
45. Barbara Trampier & Steven Houska  
150 Echo Lake Circle  
Byrnes Mill MO 63025
46. Thomlison, Toma and Tina  
154 Echo Lake Circle  
Byrnes Mill MO 63025
47. Mayfield, Donald and Laurel  
158 Echo Lake Circle ( 636-677-1041? )  
Byrnes Mill MO 63025
48. Etter, Bob and Teresa  
162 Echo Lake Circle  
Byrnes Mill MO 63025
49. Martin, Steve and Diana  
166 Echo Lake Circle  
Byrnes Mill MO 63025
50. Brewer, Jim and Nancy -- Mrs. Jesse Hayes  
170 Echo Lake Circle  
Byrnes Mill MO 63025
51. Yount, Nick and Amy  
174 Echo Lake Circle,  
Byrnes Mill MO 63025

52. Burnett, Al and Ellenor  
178 Echo Lake Circle  
Byrnes Mill MO 63025
53. Nicholson, Christopher and Elizabeth  
182 Echo Lake Circle  
Byrnes Mill MO 63025
54. Ponder, Glennon and Faye  
186 Echo Lake Circle  
Byrnes Mill MO 63025  
636-677-5678
55. VACANT LOT  
190 Echo Lake Circle  
Byrnes Mill MO 63025
56. Kohl, Mark and Bonita  
194 Echo Lake Circle  
Byrnes Mill MO 63025
57. VACANT LOT  
200 Echo Lake Circle  
Byrnes Mill MO 63025
58. VACANT LOT  
204 Echo Lake Circle  
Byrnes Mill MO 63025
59. VACANT LOT  
203 Echo Lake Circle  
Byrnes Mill MO 63025
60. VACANT LOT  
199 Echo Lake Circle  
Byrnes Mill MO 63025
61. Sisson, Gil and Linda  
191 Echo Lake Circle  
Byrnes Mill MO 63025
62. VACANT LOT  
183 Echo Lake Circle  
Byrnes Mill MO 63025
63. Unger, Kenneth  
181 Echo Lake Circle  
Byrnes Mill MO 63025
64. Colbert, Paul & Mandi  
177 Echo Lake Circle  
Byrnes Mill MO 63025
65. May, Brian and Amy  
173 Echo Lake Circle  
Byrnes Mill MO 63025
66. Powell, Jason and Rebecca  
169 Echo Lake Circle  
Byrnes Mill MO 63025
67. Morris, Richard (Rick) and Lisa  
165 Echo Lake Circle  
Byrnes Mill MO 63025
68. Birdwell, Margaret  
161 Echo Lake Circle  
Byrnes Mill MO 63025
69. Kroeger, David and Gina  
157 Echo Lake Circle  
Byrnes Mill MO 63025
70. Midyett, Bob and Karen  
153 Echo Lake Circle  
Byrnes Mill MO 63025  
cell 314-452-6975
71. Friebel, Tim and Jen  
149 Echo Lake Circle  
Byrnes Mill MO 63025
72. Mitchell, Greg and Bridget  
145 Echo Lake Circle  
Byrnes Mill MO 63025
73. Brown, Jason and Christie  
141 Echo Lake Circle  
Byrnes Mill MO 63025
74. VACANT LOT  
137 Echo Lake Circle  
Byrnes Mill MO 63025
75. Rogers, Roy & Nancy  
133 Echo Lake Circle  
Byrnes Mill MO 63025
76. VACANT LOT  
127 Echo Lake Circle  
Byrnes Mill MO 63025
77. VACANT LOT  
121 Echo Lake Circle  
Byrnes Mill MO 63025
78. VACANT LOT  
113 Echo Lake Circle  
Byrnes Mill MO 63025
79. VACANT LOT  
109 Echo Lake Circle  
Byrnes Mill MO 63025
80. VACANT LOT  
105 Echo Lake Circle  
Byrnes Mill MO 63025
81. VACANT LOT  
3216 Echo Lake Drive  
Byrnes Mill MO 63025
82. Depp, David and Jerri -- Mrs. Virginia Depp  
3222 Echo Lake Drive  
Byrnes Mill MO 63025
83. VACANT LOT  
4 Broken Arrow Court  
Byrnes Mill MO 63025
84. VACANT LOT  
6 Broken Arrow Court,  
Byrnes Mill MO 63025
85. VACANT LOT  
5 Broken Arrow Court  
Byrnes Mill MO 63025
86. VACANT LOT  
3 Broken Arrow Court  
Byrnes Mill MO 63025
87. VACANT LOT  
1 Broken Arrow Court  
Byrnes Mill MO 63025  
(possibly 3216 Echo Lake Drive)
88. Emde, Bob and Deanie  
3234 Echo Lake Drive  
Byrnes Mill MO 63025
89. VACANT LOT  
3252 Echo Lake Drive  
Byrnes Mill MO 63025
90. VACANT LOT  
3256 Echo Lake Drive  
Byrnes Mill MO 63025
91. VACANT LOT  
3260 Echo Lake Drive  
Byrnes Mill MO 63025

- 92. VACANT LOT  
3264 Echo Lake Drive  
Byrnes Mill MO 63025
- 93. VACANT LOT  
3272 Echo Lake Drive  
Byrnes Mill MO 63025
- 94. Tonya Cole  
3276 Echo Lake Drive  
Byrnes Mill MO 63025
- 95. Bunton, Jim and Barb  
3280 Echo Lake Drive  
Byrnes Mill MO 63025
- 96. Lacey, Kevin and Brooke  
216 Echo Lake Circle  
Byrnes Mill MO 63025
- 97. VACANT LOT  
220 Echo Lake Circle  
Byrnes Mill MO 63025
- 98. BILL WILLIAMS CONST.  
DISPLAY HOUSE  
Echo Lake Drive,  
Byrnes Mill MO 63025  
636-677-7478

**Echo Lake Subdivision Restrictions**

Homeowners in Echo Lake have agreed to restrictions set forth in a formal declaration signed upon closing on their property and filed with Jefferson County. Following is an unofficial summary of numbered restrictions:

- 1. The size and construction of homes and buildings is set forth in the restrictions. Lots are restricted to residential use only.
- 2. No house trailers or temporary living quarters are permitted.
- 3. Plans for all buildings and landscaping must be approved in writing and construction completed within one year's time.
- 4. Driveways must be 4-inch thick concrete slab.
- 5. Roofs must be approved shingle.
- 6. Carports are not permitted.
- 7. Sewers must be approved by City of Byrnes Mill.
- 8. Set-back lines must be approved by City of Byrnes Mill.

- 9. Limit of two domestic pets per house. No animals permitted to run loose.
- 10. Exteriors of residences must be kept neat, orderly and trash-free. Weeds must be kept cut. Autos and machines not in regular use must be kept out of sight, within a permanent building.
- 11. Detached garages or outbuildings must be approved in writing, and constructed of materials equal to, and similar in aesthetic value to, the home.
- 12. Maintenance of streets and drives is the responsibility of the homeowners.
- 13. Restrictions herein can be amended by 2/3 vote of dues-paid property owners. (One vote per lot.)
- 14. Prohibited: boarding house, nursing home, rooming house, club house or road house, or any activity which becomes a nuisance.
- 15. No signs, ads or billboards. One real estate "for sale" yard sign of usual standard size per lot permitted.
- 16. Lots/homes may not be leased, sub-leased or re-subdivided without written consent of board and approval by City of Byrnes Mill.
- 17. No overnight parking on streets of subdivision. No unlicensed, disabled or infrequently-used vehicle to be parked outside in subdivision.
- 18. These restrictions are enforceable.

**Other information:**

Trash hauling shall be by only one company. This is to keep subdivision street damage by heavy trucks to a minimum. Currently, Affordable Hauling, 636-376-3891 is our hauler.

The subdivision is in Ward 2 in the City of Byrnes Mill. Our ZIP code is 63025 and our Post Office is in Eureka. (Byrnes Mill is served by three post offices and three ZIP codes are used within the city.)

Echo Lake subdivision is a "Planned Use Development" complying with ordinances of Byrnes Mill.

City of Byrnes Mill's website:  
[www.byrnesmill.org](http://www.byrnesmill.org)